

	SLTE-7.5-FM-80
HORSEPOWER (HP)	7.5
OPERATING POWER (PSI)	85-115
AIR DELIVERY (CFM)	19.8
CONTROL SYSTEM	MULTIPLE UNIT CONTROL, AUTO/ START STOP
NOISE LEVEL (dBA)	61
AIR OUTLET (NPT)	3/8" NPT
OPERATING VOLTAGE (V)	3 PHASE, 208-230/460 V, 60Hz
DIMENSIONS (L x W x H)	64" x 32" x 49"
WEIGHT (LBS)	595

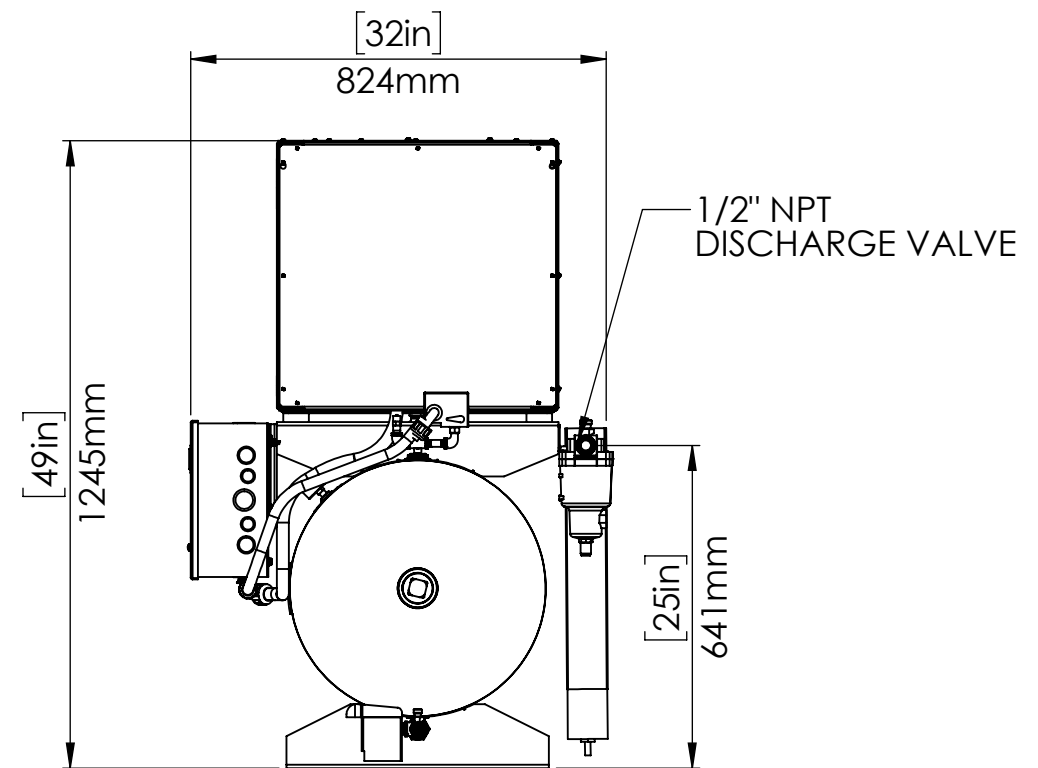
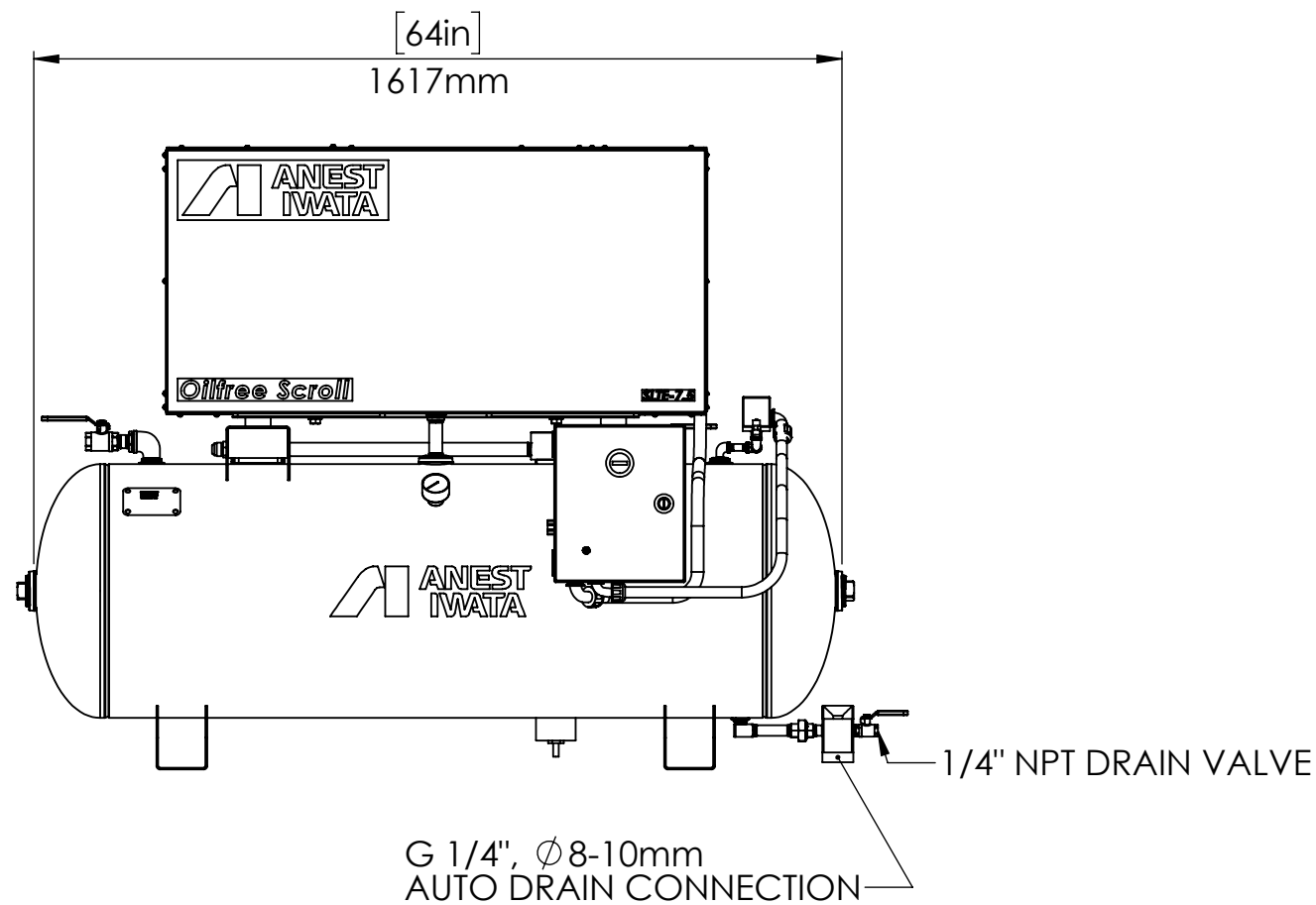

NOTES:

- 1) COMPRESSOR UNIT MUST BE INSTALLED IN A ROOM ON A FLAT FLOOR
- 2) COMPRESSOR IS AN AIR COOLED UNIT - ROOM TEMPERATURE MUST NOT EXCEED 104° F
EXHAUST DUCTS OR VENTILATING FAN MUST BE INSTALLED IF ROOM TEMPERATURE EXCEEDS 104° F
- 3) PROVIDE ADEQUATE SPACE DURING INSTALLATION FOR NECESSARY MAINTENANCE AND REPAIRS
ALLOW A MINIMUM OF 20" ON EACH SIDE AND 24" FROM TOP OF UNIT FROM WALLS
- 4) CARE MUST BE TAKEN TO INSURE COMPRESSOR UNIT DOES NOT INTAKE HOT AIR OR DUST
- 5) REFER TO INSTRUCTION MANUAL FOR ELECTRIC WIRING DIAGRAM
- 6) SPEC IS SUBJECT TO CHANGE WITHOUT NOTICE

PROPRIETARY AND CONFIDENTIAL
THE INFORMATION CONTAINED IN THIS DRAWING IS THE SOLE PROPERTY OF ANEST IWATA. ANY REPRODUCTION IN PART OR AS A WHOLE WITHOUT THE WRITTEN PERMISSION OF ANEST IWATA IS PROHIBITED.

UNLESS OTHERWISE SPECIFIED:		NAME	DATE	ANEST IWATA Air Engineering Inc.
DIMENSIONS ARE SHOWN IN INCHES AND MILLIMETERS		DRAWN	AMM 4/15/20	
		CHECKED	AGH 4/21/20	TITLE: SLTE-7.5-FM-80 OIL-FREE SCROLL UNIT TANK MOUNT COMPRESSOR FILTER MEMBRANE DRYER
		ENG APPR.		
		MFG APPR.		
		Q.A.		
INTERPRET GEOMETRIC TOLERANCING PER:		COMMENTS:		SIZE DWG. NO. REV B SLTE-7.5-FM-80-R1 1
MATERIAL ASS'Y				
PART NO.				
DO NOT SCALE DRAWING		SCALE: 1:15 WEIGHT:		SHEET 1 OF 3

