

SPECIFICATIONS

MODEL NO.	SLT-5-FRD
HORSEPOWER	5HP
OPERATING PRESSURE (psi)	85-115
AIR DELIVERY (cfm)	14.8
NOISE LEVEL (dB)	68
AIR OUTLET (BALL VALVE)	1/2" NPT
OPERATING VOLTAGE	3 Phase, 208-230/460V, 60Hz
DIMENSIONS (L x W x H)	68 x 32 x 47
APPROX. WT (lbs)	TBD

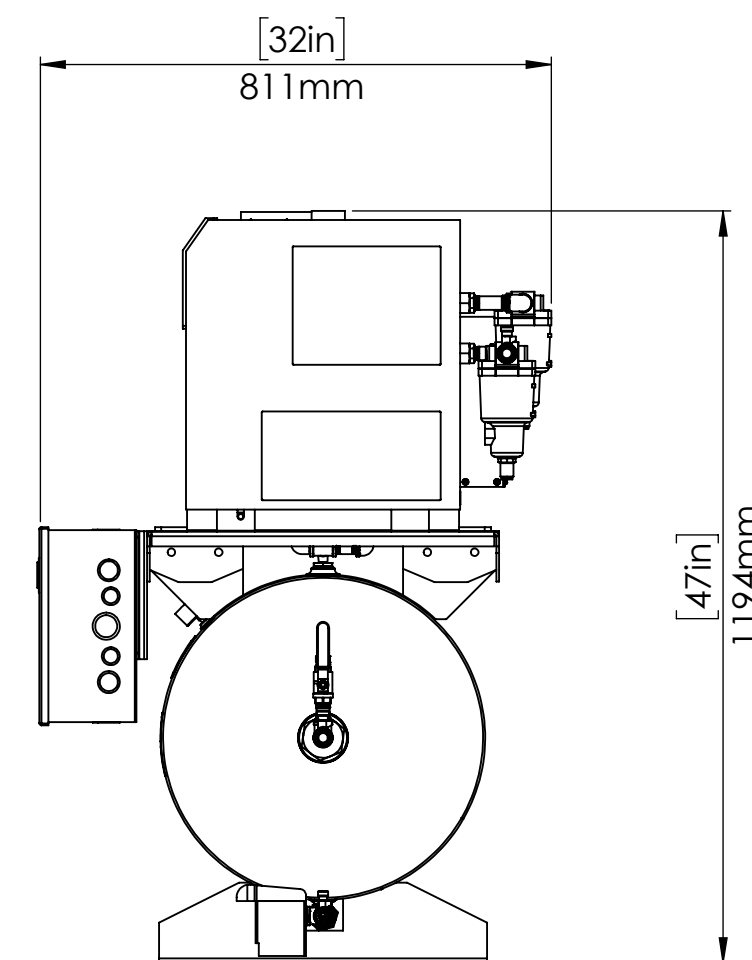

NOTES:

- 1) COMPRESSOR UNIT MUST BE INSTALLED IN A ROOM ON A FLAT FLOOR.
- 2) COMPRESSOR IS AN AIR COOLED UNIT - ROOM TEMPERATURE MUST NOT EXCEED 104°F. EXHAUST DUCTS OR VENTILATING FAN MUST BE INSTALLED IF ROOM TEMPERATURE EXCEEDS 104°F.
- 3) PROVIDE ADEQUATE SPACE DURING INSTALLATION FOR NECESSARY MAINTENANCE AND REPAIRS. ALLOW A MINIMUM OF 20" FROM EACH SIDE OF WALL, AND A MINIMUM OF 20" FROM FRONT OF UNIT, AND A MINIMUM OF 24" FROM TOP OF UNIT.
- 4) CARE MUST BE TAKEN TO INSURE COMPRESSOR UNIT DOES NOT INTAKE HOT AIR OR DUST.
- 5) REFER TO INSTRUCTION MANUAL FOR ELECTRIC WIRING DIAGRAM.
- 6) SPEC IS SUBJECT TO CHANGE WITHOUT NOTICE.

**PROPRIETARY AND CONFIDENTIAL**  
 THE INFORMATION CONTAINED IN THIS DRAWING IS THE SOLE PROPERTY OF ANEST IWATA Air Engineering Inc. ANY REPRODUCTION IN PART OR AS A WHOLE WITHOUT THE WRITTEN PERMISSION OF ANEST IWATA Air Engineering Inc. IS PROHIBITED.

UNLESS OTHERWISE SPECIFIED:		NAME	DATE	ANEST IWATA Air Engineering Inc.	
DIMENSIONS ARE IN INCHES		DRAWN	AMM	2/12/20	TITLE:
		CHECKED			<b>SLT-5-FRD-60</b>
		ENG APPR.			5HP SCROLL RECIPROCATING DRYER DUPLEX
		MFG APPR.			SIZE DWG. NO. REV
		Q.A.			<b>C SLT-5(H)-FRD-60</b>
		COMMENTS:		SCALE: 1:12 WEIGHT: SHEET 1 OF 1	
NEXT ASSY	USED ON	PART NO.		DO NOT SCALE DRAWING	
APPLICATION		ASSY			