

	SLT-20D-120
HORSEPOWER	20
OPERATING PRESSURE (PSI)	85-115 (LEAD PUMP) 75-105 (SECOND PUMP)
AIR DELIVERY (CFM)	59.4
CONTROL SYSTEM	MULTIPLE UNIT CONTROL - AUTO START/STOP
NOISE LEVEL (dB A)	79
AIR OUTLET (BALL VALVE)	1" NPT
OPERATING VOLTAGE	3 PHASE, 208-230V/460V, 60Hz
DIMENSIONS (LxWxH)	68" x 37" x 53"
APPROX. WT. (LBS.)	1080

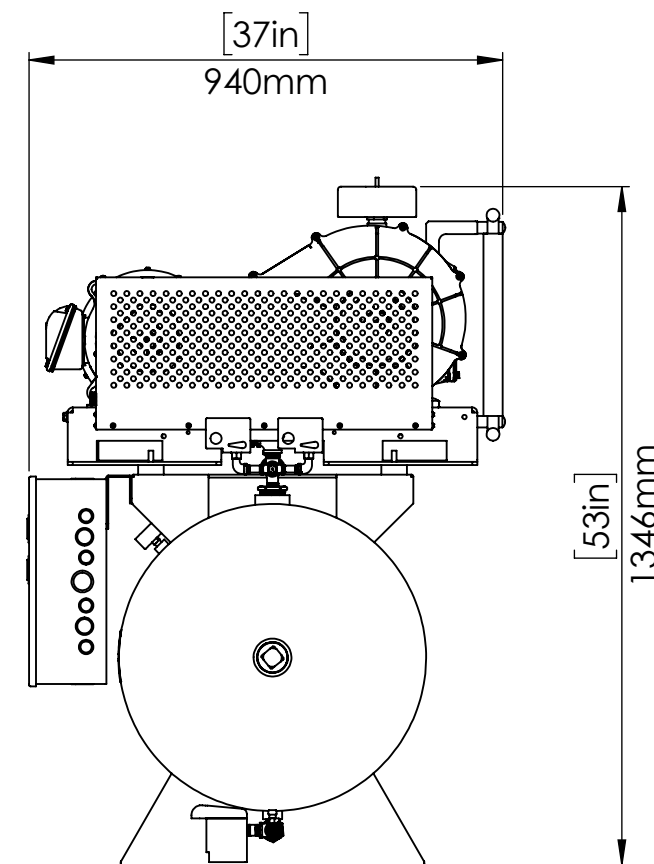
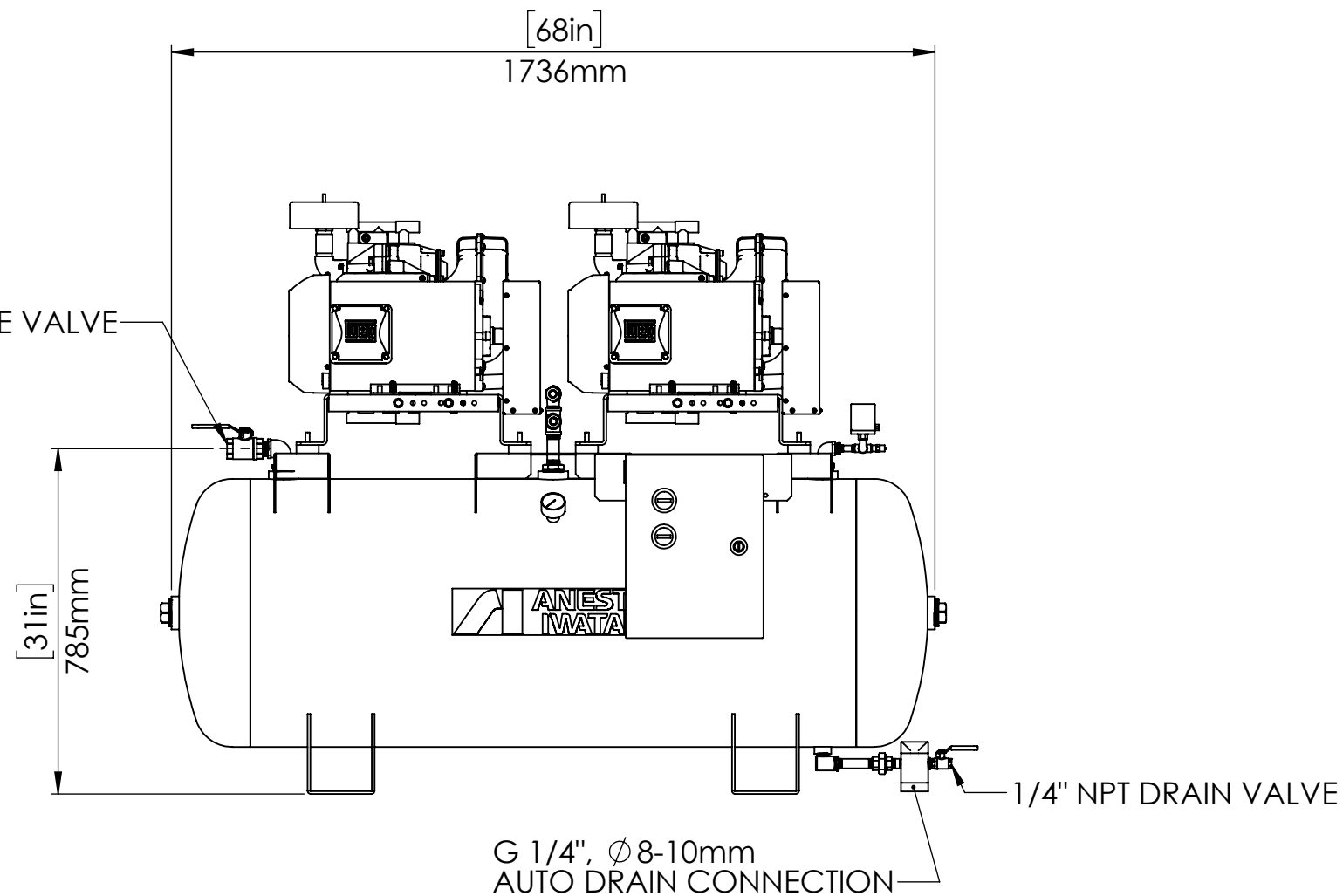

NOTES:

- 1) COMPRESSOR UNIT MUST BE INSTALLED IN A ROOM ON A FLAT FLOOR
- 2) COMPRESSOR IS AN AIR COOLED UNIT - ROOM TEMPERATURE MUST NOT EXCEED 104<MOD-DEG> F
EXHAUST DUCTS OR VENTILATING FAN MUST BE INSTALLED IF ROOM TEMPERATURE EXCEEDS 104<MOD-DEG> F
- 3) PROVIDE ADEQUATE SPACE DURING INSTALLATION FOR NECESSARY MAINTENANCE AND REPAIRS
ALLOW A MINIMUM OF 20" ON EACH SIDE AND 24" FROM TOP OF UNIT FROM WALLS
- 4) CARE MUST BE TAKEN TO INSURE COMPRESSOR UNIT DOES NOT INTAKE HOT AIR OR DUST
- 5) REFER TO INSTRUCTION MANUAL FOR ELECTRIC WIRING DIAGRAM
- 6) SPEC IS SUBJECT TO CHANGE WITHOUT NOTICE

PROPRIETARY AND CONFIDENTIAL
THE INFORMATION CONTAINED IN THIS DRAWING IS THE SOLE PROPERTY OF **ANEST IWATA**. ANY REPRODUCTION IN PART OR AS A WHOLE WITHOUT THE WRITTEN PERMISSION OF **ANEST IWATA** IS PROHIBITED.

UNLESS OTHERWISE SPECIFIED:		NAME	DATE		
DIMENSIONS SHOWN IN INCHES AND MILLIMETERS	DRAWN	AGH	4/6/20		
	CHECKED	AMM	4/8/20		
	ENG APPR.				
	MFG APPR.				
		Q.A.		TITLE:	
	COMMENTS:			SLT-20D-120 OIL-FREE-SCROLL UNIT TANK MOUNT COMPRESSOR	
MATERIAL	ASS'Y		SIZE	DWG. NO.	REV
PART NO.			B	SLT-20D-120-R1	1
DO NOT SCALE DRAWING		SCALE: 1:15		WEIGHT:	SHEET 1 OF 1